

## INSTALLATION INSTRUCTIONS

DESCRIPTION: Soft Side Cover

PART NUMBER: B4M-F17B0-V0

MODEL:2021+ Wolverine RMax2 and X2



### ⚠ WARNING

Please read and understand these instructions completely before installation to avoid possible injury, or damage to the accessory or vehicle.

- This weather enclosure is not intended to prevent injury during collisions or rollovers.
- Always wear a seat belt and a helmet when riding in this vehicle.

### WARRANTY INFORMATION:

In the United States, see your Yamaha dealer for a copy of the Yamaha Genuine Parts and Accessories Limited Warranty.

### DEALER OR INSTALLER:

These instructions contain important information for future reference and *must* be given to the customer.

### NOTICE:

Installation of this kit requires a torque wrench and should be performed by an authorized Yamaha dealer or a qualified technician. Do not tow the vehicle on an open trailer with this accessory installed, it is not designed for highway speeds.

### PARTS LIST:

No.	Part Number	Description	Qty
--	<b>B4M-F17B0-V0</b>	<b>Soft Side Cover</b>	--
①	B4M-F1711-V0	Left Side Cover	1
②	B4M-F1721-V0	Right Side Cover	1
③	B4J-F162F-V0	Male Snap	14
④	90267-32198	Blind Rivet	14
⑤	B4J-K7528-V0	M3 Nut	2
⑥	B4J-F15A2-V0	Front Strap (Attached to ①+②)	2
⑦	1XD-H1131-V0	Snap Stick	1

\* Part supplied with kit only and not available separately.

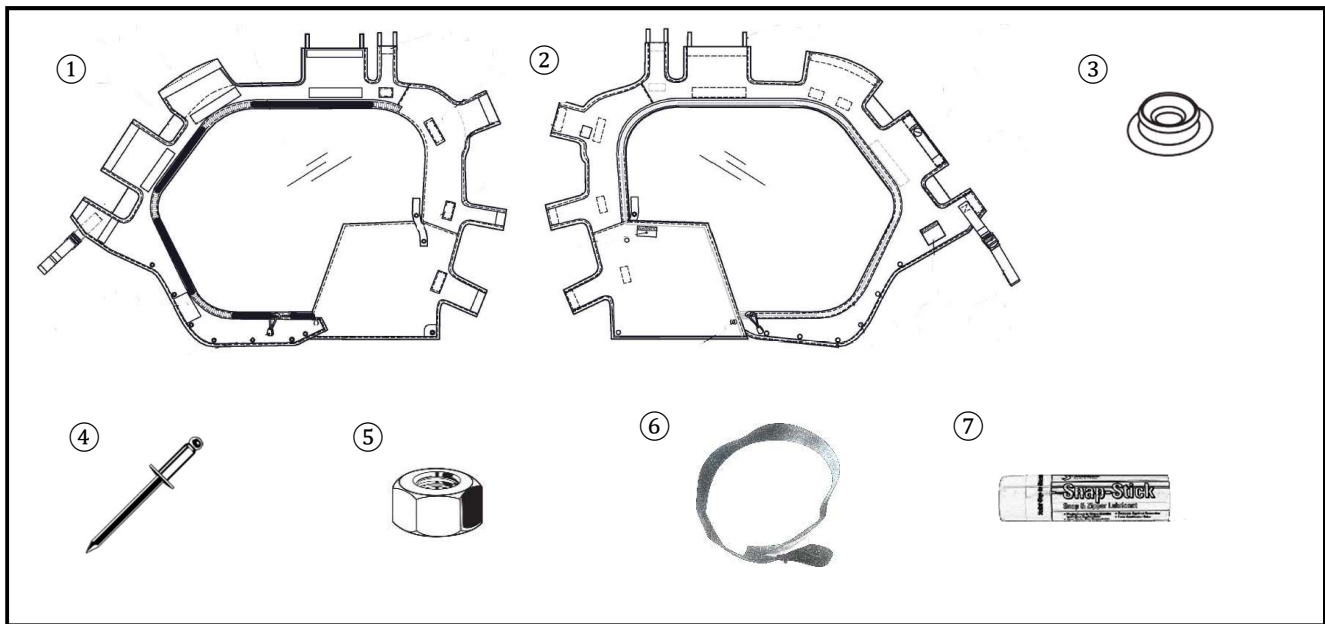
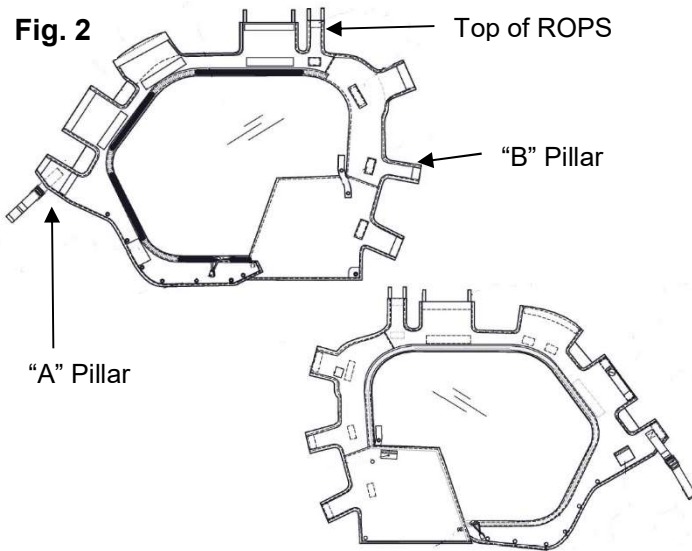

**Fig. 1**

Wrap hook and loop straps around the ROPS



**Fig. 2**



**Fig. 3**

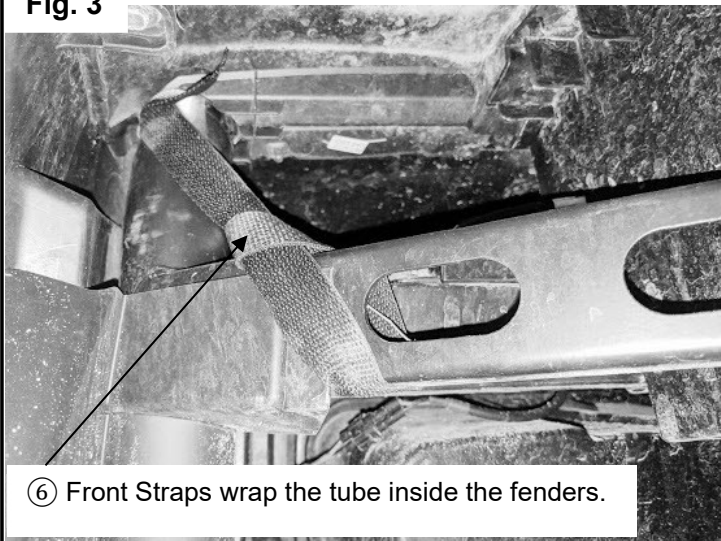

⑥ Front Straps wrap the tube inside the fenders.

## PREPARATION:

- Place the vehicle on a secure and level surface.
- Set the parking brake.
- Clean the mounting surfaces before beginning installation.
- Soft Side Covers need to be installed before the Soft Rear Window.

## INSTALLATION:

1. Start on the left side of the vehicle. Insert the hook and loop straps around the top of the ROPS. (Fig. 1 and 2)
2. Align the window over the door opening. (Fig. 1)
3. Remove the ⑥ Front Strap from the ① Left Side Cover. Remove the wrinkles and stretch the fabric front to back across the vehicle.
4. Pull the ⑥ Front Strap and loop it around the frame in the front inner fender. Route the ⑥ Front Strap up the "A" Pillar. This strap attaches to the buckle on the front of the ① Left Side Cover. (Fig. 3 and 4)
5. Once the ① Left Side Cover is adjusted, start marking the snap locations with a marker.
6. Follow steps 1 through 5 for the other side with ② Right Side Cover.

## How to Install Snaps with Rivets

1. Let the Side Covers hang. Zip all windows closed. During installation of the snaps, continue to ensure the fabric is taut and free of wrinkles before drilling and installing snaps.
2. Mark the snap locations and then drill out the holes used to mount the ③ Male Snaps using a 1/8" drill. Use a tape mark on the drill bit to set the drill depth at 1/2".
3. Use a pop rivet tool (not included in this kit) to install the ③ Male Snaps with ④ Blind Rivets. Follow these steps to install each rivet: (Fig. 6)
  - a. Insert ④ Blind Rivet into ③ Male Snap.
  - b. Place ⑤ M3 Nut on the ④ Blind Rivet.
  - c. Put ④ Blind Rivet into the body with the tool.
  - d. Pull the handle on the pop rivet tool to close the ④ Blind Rivet and complete the installation of the ③ Male Snap.
4. Pull the side covers tight and attach the rest of the ③ Male Snaps on both sides of the vehicle. Continue to make sure the fabric is taut and free of wrinkles as you install the snaps. (Fig. 5)

**Fig. 4**

Insert the ⑥ Front Strap behind the fender along both "A" Pillar ROPS.



Latch the ⑥ Front Strap and pull tight.



**MAINTENANCE:**

Periodically, check tightness of the straps. If zippers or snaps become hard to operate, apply Snap Lubricant to lubricate the side cover zippers and snaps.

**CARE AND CLEANING:**

Use a clean soft cloth and mild detergent with warm water to clean the side covers. Rinse and dry. Use Yamaha Windshield & Visor Plastic Cleaner & Conditioner (p/n ACC-PLASP-OL-11) to clean the plastic windows.

**CUSTOMER SERVICE:**

For further information see your Yamaha dealer.

**ESTIMATED TIME TO INSTALL: 1.0 HRS.**

**Fig. 5**

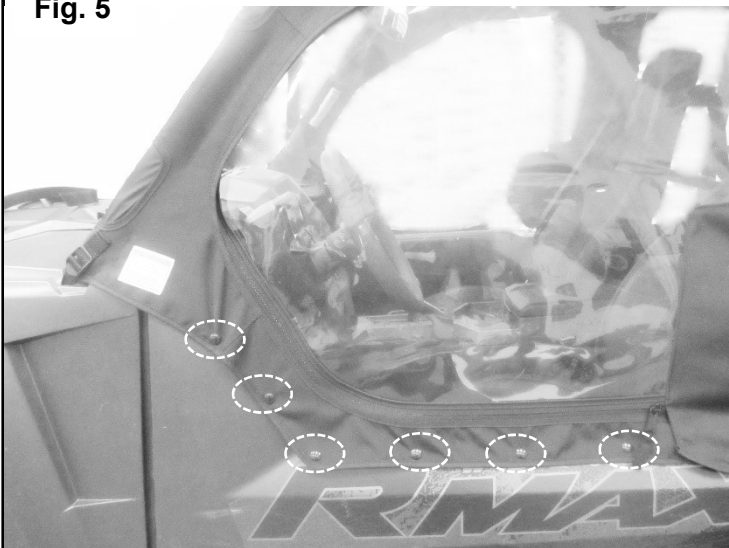

**Fig. 6**

Air Rivet Tool with ⑤



Rivet Tool with ⑤

